

## iBIO PLATRA

**iBIO PLATRA** is an universal product composed of building lime that has it 'all-in-one' (bonding, base and finish coat). On stable substrates (regular masonry in brickwork or natural stone, calcium silicate units,...) the product can bond and can give the finished appearance at the same time. On lime-hemp and concrete and unstable substrates it is recommended to use a different bonding coat first (**iBIO SPAT**). Once dried out it can be decorated with a lime wash or silicate paint. The thickness varies between 3 and 30 mm.

### Preparation of the substrate

The substrate must be clean and free of grease and dust.

### Preparation of the mortar

The content of one bag premixed powder is mixed with approx. 30% of clean water (= approx. 6 litres of water to a bag of 20 kg).

Mixing is undertaken with a slow speed electric paddle for a period of approx. 3 minutes. A creamy workable mortar is obtained, which has approx. 2 hours of open time.

### Application

**iBIO PLATRA** is applied mechanically or manually with a trowel. It can be applied as a one coat plaster or, in order to obtain a nicer finished result it is recommended to do the application in two layers : one thin layer for the bonding/base coat, and once dried out, a second layer for the final finish. The finish can be applied in several ways : flattened, trowelled, sponged or polished.

Drying time prior to an eventual decorative coat or paint (lime wash or silicate paint): min. 1 week.

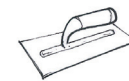
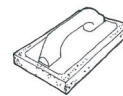
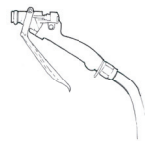
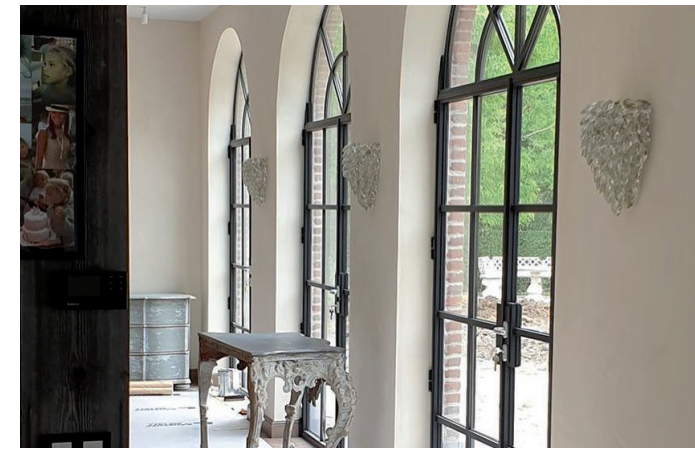

iBIO, or how can a natural product also be intelligent !

Construction lime (or natural hydraulic lime) is presented today as an alternative to cement-based products, plaster, etc. However, lime has always been present in most of our buildings, so it would be more than logical that it would start to regain its place.

Lime does indeed have indisputable properties in terms of comfort and health to a building and its inhabitants. It allows, among other things, to regulate the humidity level and will improve the thermal and acoustical insulation in a natural way. Aesthetically speaking, it also gives a certain character to your wall, which is generally always well received.

But at the moment it is mainly the ecological footprint that makes the difference ! Already a natural product at its base, it is burned at a much lower temperature than, for example, cement, and once applied to the wall, it will significantly reduce the amount of CO<sub>2</sub> in the air, since building lime requires it in its reaction.

## TECHNICAL PROPERTIES

### iBIO PLATRA \*

granular sizing: max. 0,8 mm  
bulk density: ca. 1400 kg/m<sup>3</sup>  
vapour diffusion resistance ( $\mu$ ): 10  
fire resistance classification: A1 (non-flammable)  
consumption: 14 kg/m<sup>2</sup>/cm  
pallet content: 60 x 20 kg = 1200 kg



Tel: +32 78 150 006  
E-mail: [info@ibiolime.com](mailto:info@ibiolime.com)  
Website: [www.ibiolime.com](http://www.ibiolime.com)

# iBIO

ONE-COAT PLASTER SYSTEM WITH  
BUILDING LIME

Warm comfort and healthy environment in the interior !

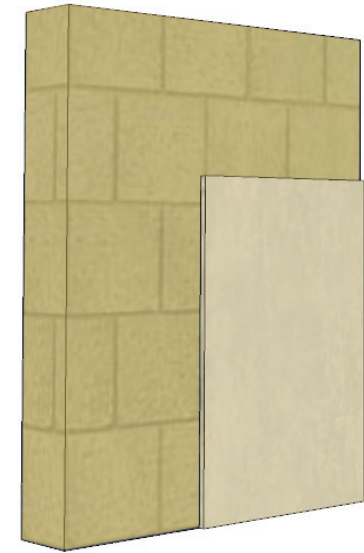

iBIO PLATRA



\* product approved by LEED  
(Leadership in Energy and Environmental Design)  
and in accordance with the standards EN 459-1 (binder NHL)  
and EN 998-1 (mortar)

iBIO